



JOINT

MORTAR-GROUTED JOINT

TOPS-JOINT

FOR REBAR TYPE – BS4449 : 2005 B500B&B500C SIZE 20~40

TOPS-JOINT complies with both Acceptance Criteria for Mechanical Connector Systems for Steel Reinforcing Bars(ICC-ES AC133 TYPE 2) and ISO15835.

TOPS-JOINT is a mortar-grouted joint, able to join any types of rebar. This is the most suitable joint for the column & wall precast construction method.

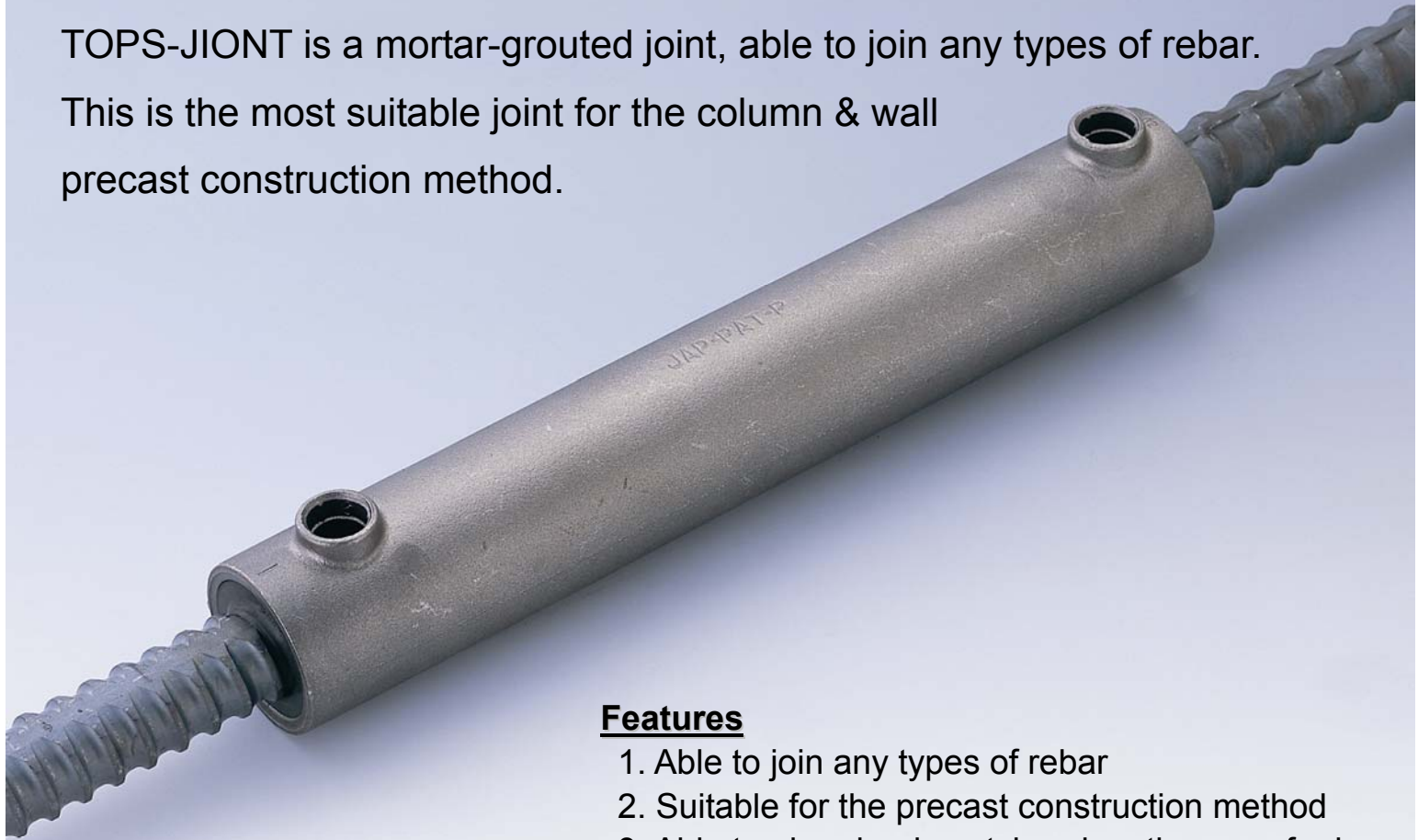

Features

1. Able to join any types of rebar
2. Suitable for the precast construction method
3. Able to absorb mismatch or length error of rebar

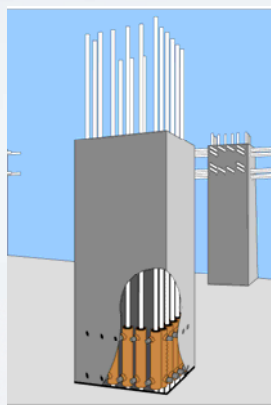

PRECAST METHOD(COLUMN)

TTK MORTAR & CONSTRUCTION TOOLS

MORTAR-GROUTED JOINT TOPS-JOINT

■ Mechanical Properties

Model	Standard	Grade	0.2%Proof Stress (N/mm ²) min	Tensile Strength (N/mm ²) min	Elongation (%) min	Hardness (HB)
6R-DS	BS EN 1564	EN-GLS-450-10	310 and over	450 and over	10 and over	160-221
7R-D ~ 13/14R-DS		EN-GLS-700-2	420 and over	700 and over	2 and over	229-302

■ Dimensions & Mortar Injection Volume

(Unit: mm)

Model	Bar Size	Length (L)	Outer Diameter (φ)	Diameter of Bar Insertion		Mortar Inlet Position (a)	Mortar Outlet Position (b)	Inlet & Outlet Diameter (φ3)	Length of Seal insert part (s)	Position of bar stopper		Mortar injection volume (kg)
				Wide (φ1)	Narrow (φ2)					Wide (L1)	Narrow (L2)	
6R-DS	20	230	49	36	25	46	198	26	15	115	110	0.57
7R-DS	22	270	53	44	28	46	238	26	15	135	130	0.81
8R-DS	25	300	58	48	32	46	268	26	15	150	145	0.99
9R-DS	28	340	63	51	36	46	308	26	15	170	165	1.25
10R-DS	32	380	66	55	40	46	348	26	15	190	185	1.46
13/14R-DS	40	510	82	66	51	46	478	26	15	255	250	2.89

t = 5

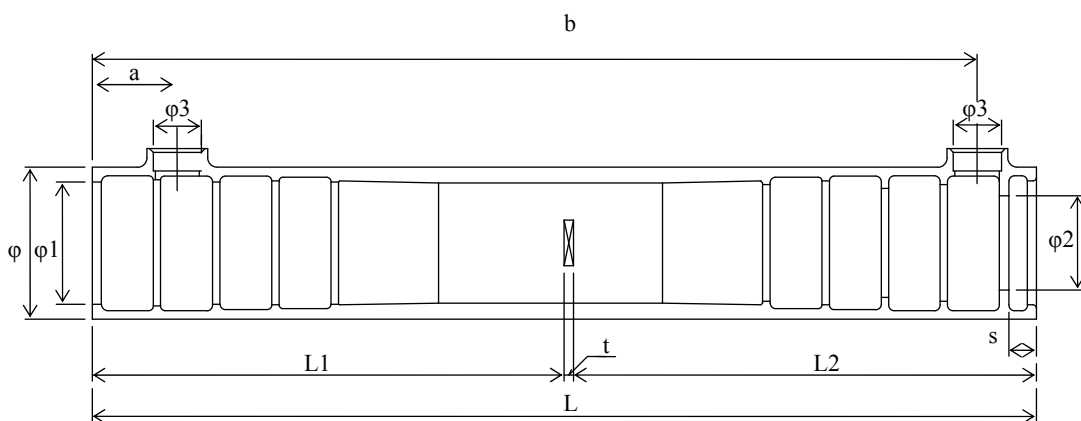

Contact information

Tokyo Tekko Co., Ltd. Overseas Division
 ADD : 11th Fl. Stage Bldg., 2-7-2 Fujimi, Chiyoda-ku, Tokyo 102-0071, Japan
 TEL : +81-3-6272-3657 FAX : +81-3-5276-9713
 http : //www.tokyotekko.co.jp
 E-mail : ttk_overseas@tokyotekko.co.jp